

DIRECT CURRENT MICRO SWITCHES ZX-10 SERIES

Specifications

Operating Speed	0.01mm-1m/sec
Operating Frequency	Mechanical: 240ops/min Electrical: 20 ops/min
Insulation Resistance	>100MΩ@500V DC
Contact Resistance	<15mΩ
Rated Current/Voltage	10A 125VDC 3A 250VDC
Dielectric Strength	1000VAC for 1 min between current carrying parts 1500VAC for 1 min between non-current carrying parts
Service Life	Mechanically 1.0 x 10 ⁶ (operations) Electrically 1 x 10 ⁵ (operations)
Operating Temperature	-40~+105°C (-40~221°F)
Humidity	35%~85%RH
Degree of Protection	IP00

Definitions of Operating Characteristics

OF Operating Force	PT Pretravel
RF Releasing Force	MD Movement Differential
OT Overtravel	OP Operating Position
TT Total Travel	PO Travel to Positive Opening

Ratings

Item	Non-inductive load (A)				Inductive load (A)			
	Resistive load		Bulb load		Inductive load		Motor load	
	NC	NO	NC	NO	NC	NO	NC	NO
Rated VDC								
8	10	3	1.5	10	10	5	2.5	
14	10	3	1.5	10	10	5	2.5	
30	10	3	1.5	10	10	5	2.5	
125	10	3	1.5	7.5	6	5	2.5	
250	3	1.5	0.75	2	1.5	2	1.5	

Terminal Dimensions*

Unit: mm

-P1

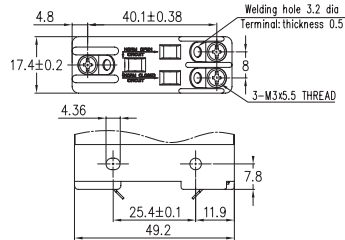

-P2

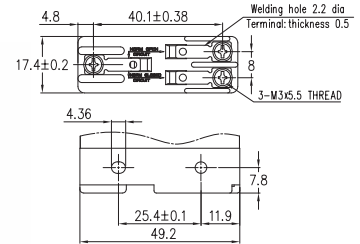

-S1

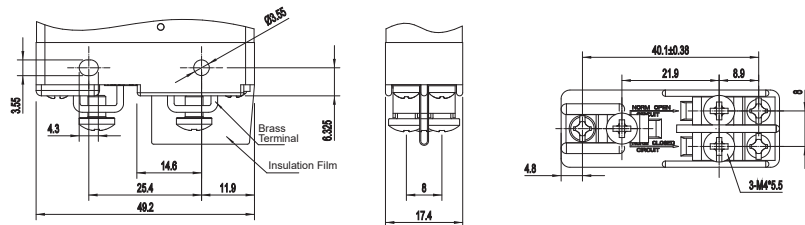
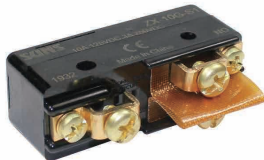

*Add corresponding suffix for desirable terminal style

Product Dimensions Unit: mm

ZX-10G

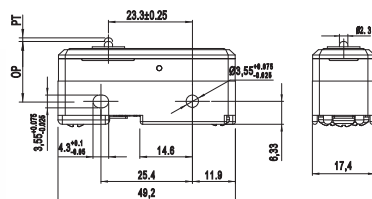

Operating Characteristics

- OF_{max} 5.00N
- RF_{min} 1.12N
- PT_{max} 0.9mm
- OT_{min} 0.13mm
- MD_{max} 0.18mm
- OP 15.9*0.4mm

ZX-10GD

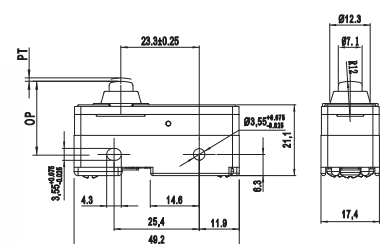

Operating Characteristics

- OF_{max} 5.00N
- RF_{min} 1.12N
- PT_{max} 0.9mm
- OT_{min} 1.6mm
- MD_{max} 0.18mm
- OP 21.2*0.5mm

DIRECT CURRENT MICRO SWITCHES ZX-10 SERIES

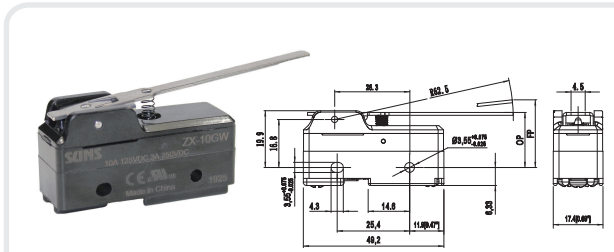

ZX-10GW

Operating Characteristics

- OF_{max} 1.08N
- RF_{min} 0.14N
- FP_{max} 34.6mm
- OT_{min} 4.8mm
- MD_{max} 3.9mm
- OP 21.1*0.8mm

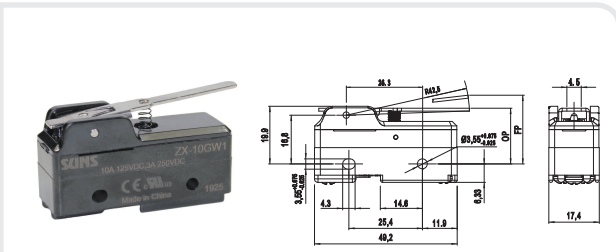

ZX-10GW1

Operating Characteristics

- OF_{max} 1.76N
- RF_{min} 0.23N
- FP_{max} 30.0mm
- OT_{min} 3.7mm
- MD_{max} 2.8mm
- OP 20.9*0.8mm

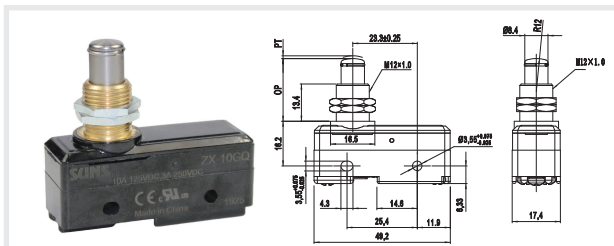

ZX-10GQ

Operating Characteristics

- OF_{max} 5.00N
- RF_{min} 1.12N
- PT_{max} 0.9mm
- OT_{min} 1.6mm
- MD_{max} 0.18mm
- OP 21.8*0.8mm

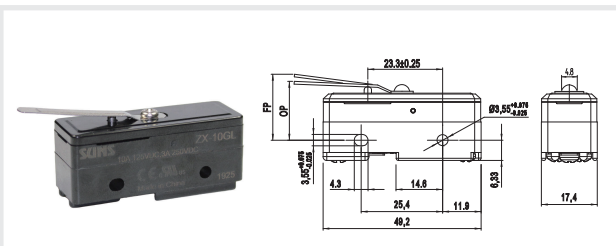

ZX-10GL

Operating Characteristics

- OF_{max} 1.96N
- RF_{min} 0.14N
- FP_{max} 22.1mm
- OT_{min} 1.6mm
- MD_{max} 2.3mm
- OP 17.4*0.8mm

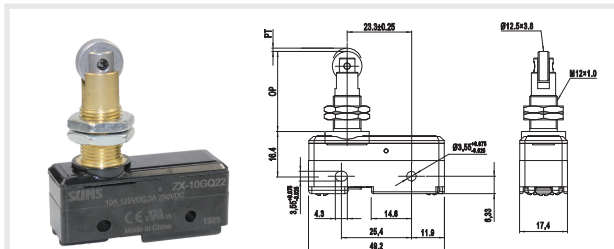

ZX-10GQ22

Operating Characteristics

- OF_{max} 5.00N
- RF_{min} 1.12N
- PT_{max} 0.9mm
- OT_{min} 3.6mm
- MD_{max} 0.18mm
- OP 33.4*1.2mm

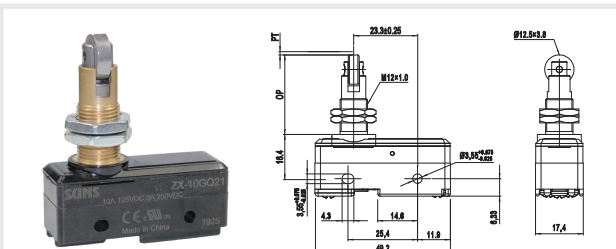

ZX-10GQ21

Operating Characteristics

- OF_{max} 5.00N
- RF_{min} 1.12N
- PT_{max} 0.9mm
- OT_{min} 3.6mm
- MD_{max} 0.18mm
- OP 33.4*1.2mm

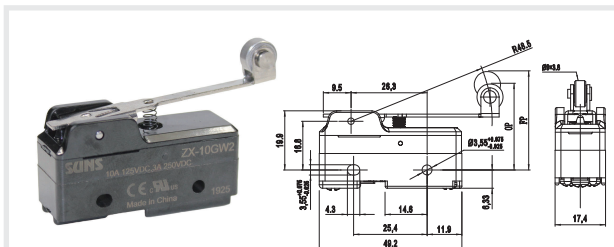

ZX-10GW2

Operating Characteristics

- OF_{max} 1.42N
- RF_{min} 0.21N
- FP_{max} 40.5mm
- OT_{min} 4.0mm
- MD_{max} 3.0mm
- OP 32.2*0.8mm

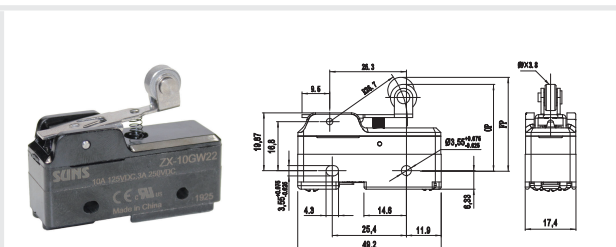

ZX-10GW22

Operating Characteristics

- OF_{max} 2.16N
- RF_{min} 0.34N
- FP_{max} 37.1mm
- OT_{min} 2.4mm
- MD_{max} 1.7mm
- OP 32.2*0.8mm